

REP

Datasheet

Tuesday, 26th of June 2018

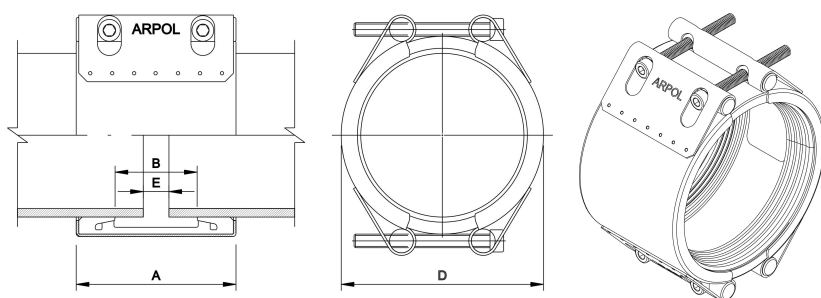

	Quality W5	
	AISI	DIN
Casing	316 L	1.4404
Bars	316 L	1.4404
Bolts	316	1.4401

Rubber gasket

EPDM

Suitable for water, air and some chemical products

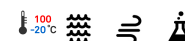

Range	Item	PS	Fac	Lock			Dimensions				Weight	Tolerances			
				Num	Diam	Tor	A	B	D	E		α	\ominus	$\Delta\emptyset$	Crack
mm		bar				Nm	mm	mm	mm	mm	kg	$^\circ$	mm	mm	
338 - 350	IBZR 338-350 A4E12	12	1.5	2	M12	30	199	142	373	15	9.4	2	3	5	100
338 - 350	ICZR 338-350 A4E16	16	1.5	2	M12	30	200	142	374	15	10.7	2	3	5	100
425 - 437	IBZR 425-437 A4E9	9	1.5	2	M12	40	199	142	460	15	10.5	2	3	5	100
425 - 437	ICZR 425-437 A4E13	13	1.5	2	M12	30	200	142	461	15	12.3	2	3	5	100
425 - 437	IDZR 425-437 A4E16	16	1.5	2	M12	30	201	142	462	15	13.8	2	3	5	100
504 - 520	IBZR 504-520 A4E8	8	1.5	2	M12	35	199	142	543	15	11.8	2	3	6	100
504 - 520	ICZR 504-520 A4E10	10	1.5	2	M12	35	200	142	544	15	13.5	2	3	6	100
504 - 520	IFZR 504-520 A4E20	20	1.5	2	M16	45	204	142	548	15	23.5	2	3	6	100

PS: Working pressure **Num:** Number of locks **Diam:** Bolt diameter **Tor:** Torque rate **Fac:** Factor test pressure: Factor x PS

α Maximum angular deflection

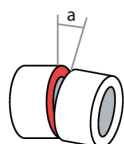

\ominus Maximum misalignment

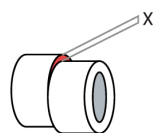

$\Delta\emptyset$ Maximum diameter difference

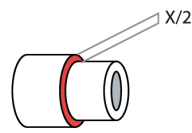

Dim E: Maximum gap width

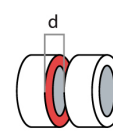

Crack: Maximum crack width

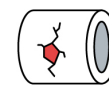

Remarks:

- For the correct operation of the coupling, fitting instructions must be respected. [REP](#)
- Inner steel band may be required for special applications (e.g. Risk of negative pressure)

Except errors / Subject to change without prior notice

REP

Datasheet

Tuesday, 26th of June 2018

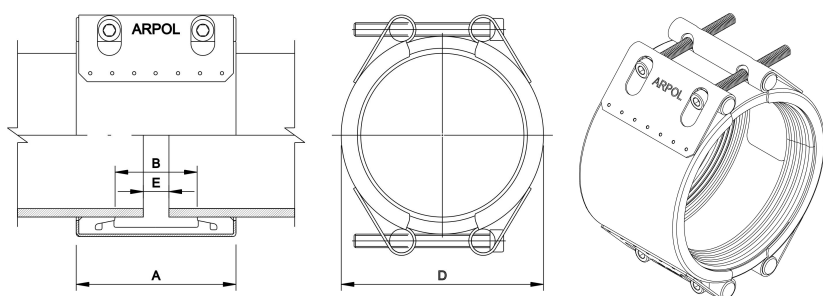

	Quality W5	
	AISI	DIN
Casing	316 L	1.4404
Bars	316 L	1.4404
Bolts	316	1.4401

Rubber gasket
EPDM
Suitable for water, air and some chemical products



Range	Item	PS	Fac	Lock			Dimensions				Weight	Tolerances			
				Num	Diam	Tor	A	B	D	E		α	\odot	$\Delta\emptyset$	Crack
mm		bar				Nm	mm	mm	mm	mm	kg	°	mm	mm	mm
583 - 599	IBZR 583-599 A4E7	7	1.5	2	M12	35	199	142	622	15	12.8	2	3	6	100
583 - 599	IDZR 583-599 A4E12	12	1.5	2	M12	35	201	142	624	15	16.7	2	3	6	100
583 - 599	IFZR 583-599 A4E19	19	1.5	2	M16	50	204	142	627	15	25.6	2	3	6	100
665 - 681	IBZR 665-681 A4E6	6	1.5	2	M12	45	199	142	704	15	13.8	2	3	6	100
665 - 681	IDZR 665-681 A4E10	10	1.5	2	M12	45	201	142	706	15	18.2	2	3	6	100
665 - 681	IFZR 665-681 A4E16	16	1.5	2	M16	60	204	142	709	15	27.8	2	3	6	100
734 - 750	IBZR 734-750 A4E6	6	1.5	2	M12	45	199	142	773	15	14.7	2	3	6	100
734 - 750	IEZR 734-750 A4E11	11	1.5	2	M16	60	202	142	776	15	24.4	2	3	6	100

PS: Working pressure **Num:** Number of locks **Diam:** Bolt diameter **Tor:** Torque rate **Fac:** Factor test pressure: Factor x PS

α Maximum angular deflection

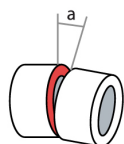

\odot Maximum misalignment

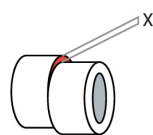

$\Delta\emptyset$ Maximum diameter difference

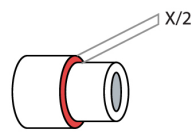

Dim E: Maximum gap width

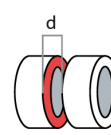

Crack: Maximum crack width

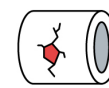

Remarks:

- For the correct operation of the coupling, fitting instructions must be respected. [REP](#)
- Inner steel band may be required for special applications (e.g. Risk of negative pressure)

Except errors / Subject to change without prior notice

REP

Datasheet

Tuesday, 26th of June 2018

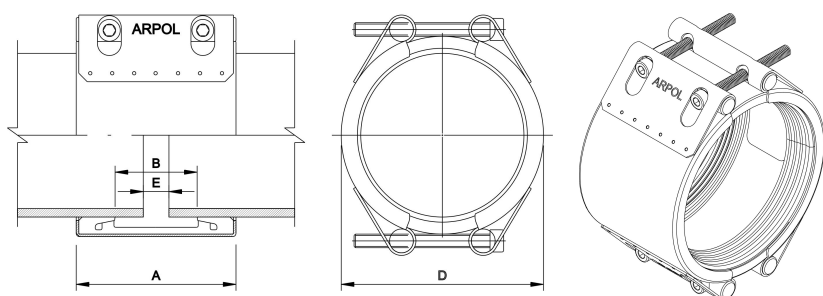

	Quality W5	
	AISI	DIN
Casing	316 L	1.4404
Bars	316 L	1.4404
Bolts	316	1.4401

Rubber gasket
EPDM
Suitable for water, air and some chemical products



Range	Item	PS	Fac	Lock			Dimensions				Weight	Tolerances			
				Num	Diam	Tor	A	B	D	E		α	\odot	$\Delta\emptyset$	Crack
mm		bar				Nm	mm				kg	$^\circ$	mm	mm	
734 - 750	IGZR 734-750 A4E18	18	1.5	2	M20	80	206	142	780	15	39.2	2	3	6	100
820 - 836	IBZR 820-836 A4E5	5	1.5	2	M12	50	199	142	859	15	15.8	2	3	6	100
820 - 836	ICZR 820-836 A4E6	6	1.5	2	M12	50	200	142	860	15	18.4	2	3	6	100
820 - 836	IEZR 820-836 A4E10	10	1.5	2	M16	70	202	142	862	15	26.2	2	3	6	100
820 - 836	IGZR 820-836 A4E16	16	1.5	2	M20	90	206	142	866	15	41.9	2	3	6	100
921 - 937	ICZR 921-937 A4E6	6	1.5	2	M12	60	200	142	961	15	22.5	2	3	6	100
921 - 937	IFZR 921-937 A4E12	12	1.5	2	M16	80	204	142	965	15	34.6	2	3	6	100
924	IHFZR 924A4E18	18	1.5	2	M20	100	204	142	976	15	61.7	1	2	3	100

PS: Working pressure **Num:** Number of locks **Diam:** Bolt diameter **Tor:** Torque rate **Fac:** Factor test pressure: Factor x PS

α Maximum angular deflection

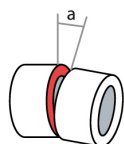

\odot Maximum misalignment

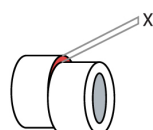

$\Delta\emptyset$ Maximum diameter difference

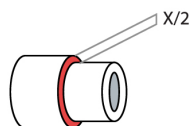

Dim E: Maximum gap width

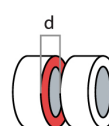

Crack: Maximum crack width



Remarks:

- For the correct operation of the coupling, fitting instructions must be respected. [REP](#)
- Inner steel band may be required for special applications (e.g. Risk of negative pressure)

Except errors / Subject to change without prior notice

REP

Datasheet

Tuesday, 26th of June 2018

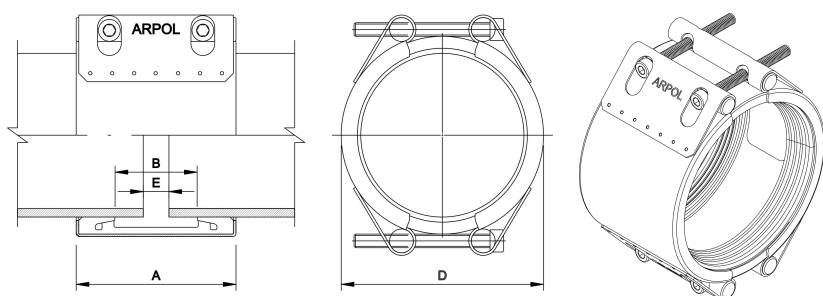

	Quality W5	
	AISI	DIN
Casing	316 L	1.4404
Bars	316 L	1.4404
Bolts	316	1.4401
Rubber gasket		
EPDM		
Suitable for water, air and some chemical products		



Range	Item	PS	Fac	Lock			Dimensions				Weight	Tolerances			
				Num	Diam	Tor	A	B	D	E		α	\odot	$\Delta\emptyset$	Crack
mm		bar				Nm	mm				kg	$^\circ$	mm	mm	
1023 - 1039	ICZR 1023-1039 A4E5	5	1.5	2	M12	70	200	142	1063	15	24.1	2	3	6	100
1023 - 1039	IEZR 1023-1039 A4E8	8	1.5	2	M16	90	202	142	1065	15	30.4	2	3	6	100
1023 - 1039	IFZR 1023-1039 A4E10	10	1.5	2	M16	90	204	142	1067	15	37.3	2	3	6	100
1026	IHFZR 1026A4E16	16	1.5	2	M20	120	204	142	1078	15	66.6	1	2	3	100
1220 - 1236	ICZR 1220-1236 A4E4	4	1.5	2	M16	100	200	142	1260	15	27.9	2	3	6	100
1220 - 1236	IEZR 1220-1236 A4E7	7	1.5	2	M16	100	202	142	1262	15	34.5	2	3	6	100
1220 - 1236	IGZR 1220-1236 A4E11	11	1.5	2	M20	140	206	142	1266	15	54.8	2	3	6	100
1229	IHFZR 1229A4E14	14	1.5	2	M20	140	204	142	1281	15	76.3	1	2	3	100

PS: Working pressure **Num:** Number of locks **Diam:** Bolt diameter **Tor:** Torque rate **Fac:** Factor test pressure: Factor x PS

α Maximum angular deflection

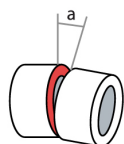

\odot Maximum misalignment

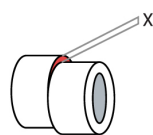

$\Delta\emptyset$ Maximum diameter difference

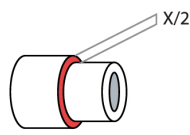

Dim E: Maximum gap width

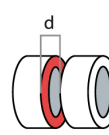

Crack: Maximum crack width

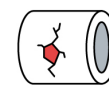

Remarks:

- For the correct operation of the coupling, fitting instructions must be respected. [REP](#)
- Inner steel band may be required for special applications (e.g. Risk of negative pressure)

Except errors / Subject to change without prior notice

REP

Datasheet

Tuesday, 26th of June 2018

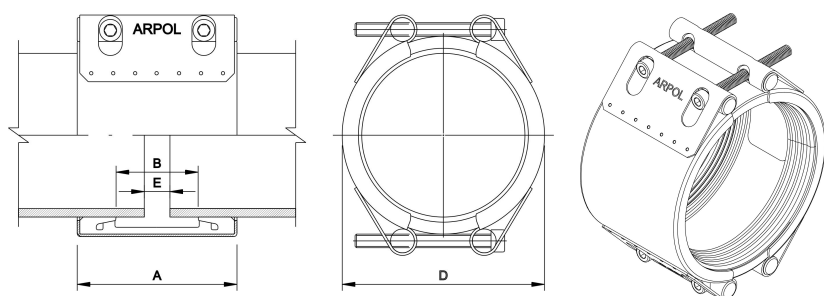

	Quality W5	
	AISI	DIN
Casing	316 L	1.4404
Bars	316 L	1.4404
Bolts	316	1.4401
Rubber gasket		
EPDM		
Suitable for water, air and some chemical products		



Range	Item	PS	Fac	Lock			Dimensions				Weight	Tolerances			
				Num	Diam	Tor	A	B	D	E		α	\odot	$\Delta\emptyset$	Crack
mm		bar				Nm	mm				kg	$^\circ$	mm	mm	
1431 - 1447	IEZR 1431-1447 A4E6	6	1.5	2	M16	120	202	142	1473	15	38.9	2	3	6	100
1434	IHFZR 1434A4E12	12	1.5	2	M20	160	204	142	1486	15	86.1	1	2	3	100
1635 - 1651	IEZR 1635-1651 A4E5	5	1.5	2	M16	140	202	142	1677	15	43.2	1	3	6	100
1635 - 1651	IFZR 1635-1651 A4E7	7	1.5	2	M20	180	204	142	1679	15	55.8	1	3	6	100
1839 - 1855	IEZR 1839-1855 A4E4	4	1.5	2	M16	160	202	142	1881	15	47.5	1	3	6	100
1839 - 1855	IFZR 1839-1855 A4E6	6	1.5	2	M20	200	204	142	1883	15	61.2	1	3	6	100
1842	IHFZR 1842A4E9	9	1.5	2	M20	200	204	142	1894	15	105.7	1	2	3	100

PS: Working pressure **Num:** Number of locks **Diam:** Bolt diameter **Tor:** Torque rate **Fac:** Factor test pressure: Factor x PS

α Maximum angular deflection

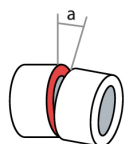

\odot Maximum misalignment

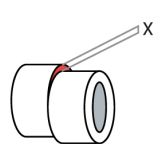

$\Delta\emptyset$ Maximum diameter difference

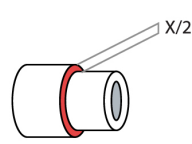

Dim E: Maximum gap width

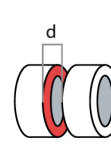

Crack: Maximum crack width



Remarks:

- For the correct operation of the coupling, fitting instructions must be respected. [REP](#)
- Inner steel band may be required for special applications (e.g. Risk of negative pressure)

Except errors / Subject to change without prior notice

REP

Datasheet

Thursday, 28th of June 2018

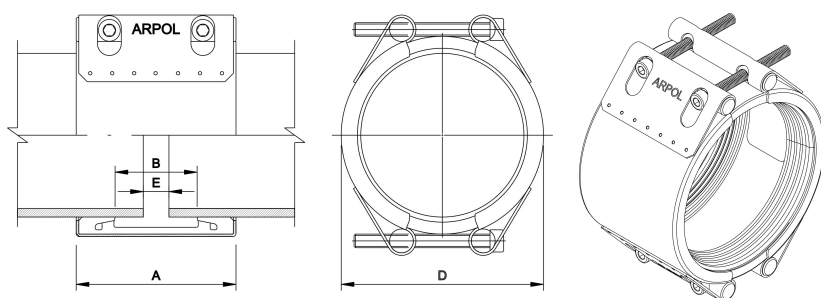

	Quality W5	
	AISI	DIN
Casing	316 L	1.4404
Bars	316 L	1.4404
Bolts	316	1.4401

Rubber gasket

EPDM

Suitable for water, air and some chemical products

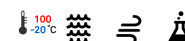

Range	Item	PS	Fac	Lock		Dimensions				Weight	Tolerances				
				Num	Diam	Tor	A	B	D		E	α	\ominus	$\Delta\emptyset$	Crack
mm		bar				Nm	mm	mm	mm	mm	kg	$^\circ$	mm	mm	
271 - 283	IBZR 271-283 A4E15	15	1.5	2	M12	25	199	142	306	15	8.5	2	3	5	100
320 - 332	IBZR 320-332 A4E12	12	1.5	2	M12	30	199	142	355	15	9.1	2	3	5	100
372 - 384	IBZR 372-384 A4E11	11	1.5	2	M12	35	199	142	407	15	9.8	2	3	5	100
425 - 437	IBZR 425-437 A4E9	9	1.5	2	M12	40	199	142	460	15	10.5	2	3	5	100
477 - 489	IBZR 477-489 A4E8	8	1.5	2	M12	45	199	142	512	15	11.2	2	3	5	100
525 - 541	IBZR 525-541 A4E8	8	1.5	2	M12	35	199	142	564	15	12	2	3	6	100
548 - 564	IBZR 548-564 A4E8	8	1.5	2	M12	35	199	142	587	15	12.3	2	3	6	100
614 - 630	IBZR 614-630 A4E6	6	1.5	2	M12	40	199	142	653	15	13.2	2	3	6	100

PS: Working pressure **Num:** Number of locks **Diam:** Bolt diameter **Tor:** Torque rate **Fac:** Factor test pressure: Factor x PS

α Maximum angular deflection

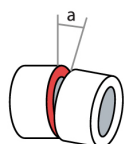

\ominus Maximum misalignment

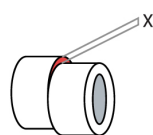

$\Delta\emptyset$ Maximum diameter difference

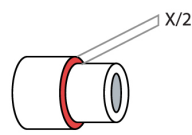

Dim E: Maximum gap width

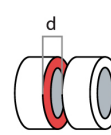

Crack: Maximum crack width

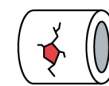

Remarks:

- For the correct operation of the coupling, fitting instructions must be respected. [REP](#)
- Inner steel band may be required for special applications (e.g. Risk of negative pressure)

Except errors / Subject to change without prior notice

REP

Datasheet

Thursday, 28th of June 2018

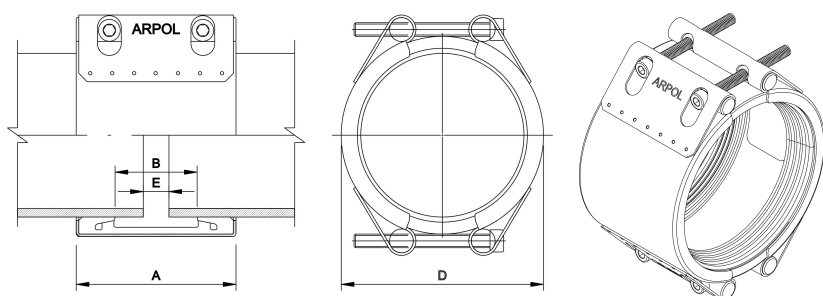

	Quality W5	
	AISI	DIN
Casing	316 L	1.4404
Bars	316 L	1.4404
Bolts	316	1.4401

Rubber gasket
EPDM
Suitable for water, air and some chemical products



Range	Item	PS	Fac	Lock			Dimensions				Weight	Tolerances			
				Num	Diam	Tor	A	B	D	E		α	\odot	$\Delta\emptyset$	Crack
mm		bar				Nm	mm				kg	$^\circ$	mm	mm	
650 - 666	IBZR 650-666 A4E6	6	1.5	2	M12	45	199	142	689	15	13.7	2	3	6	100
714 - 730	IBZR 714-730 A4E6	6	1.5	2	M12	45	199	142	753	15	14.5	2	3	6	100
748 - 764	IBZR 748-764 A4E6	6	1.5	2	M12	45	199	142	787	15	14.9	2	3	6	100
820 - 836	IBZR 820-836 A4E5	5	1.5	2	M12	50	199	142	859	15	15.8	2	3	6	100
851 - 867	ICZR 851-867 A4E6	6	1.5	2	M12	60	200	142	891	15	21.4	2	3	6	100
921 - 937	ICZR 921-937 A4E6	6	1.5	2	M12	60	200	142	961	15	22.5	2	3	6	100
957 - 973	ICZR 957-973 A4E5	5	1.5	2	M12	60	200	142	997	15	23	2	3	6	100
1023 - 1039	ICZR 1023-1039 A4E5	5	1.5	2	M12	70	200	142	1063	15	24.1	2	3	6	100

PS: Working pressure **Num:** Number of locks **Diam:** Bolt diameter **Tor:** Torque rate **Fac:** Factor test pressure: Factor x PS

α Maximum angular deflection

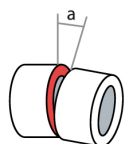

\odot Maximum misalignment

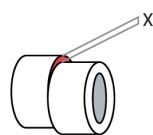

$\Delta\emptyset$ Maximum diameter difference

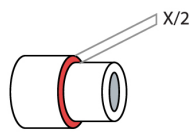

Dim E: Maximum gap width

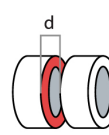

Crack: Maximum crack width

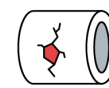

Remarks:

- For the correct operation of the coupling, fitting instructions must be respected. [REP](#)
- Inner steel band may be required for special applications (e.g. Risk of negative pressure)

Except errors / Subject to change without prior notice

REP

Datasheet

Thursday, 28th of June 2018

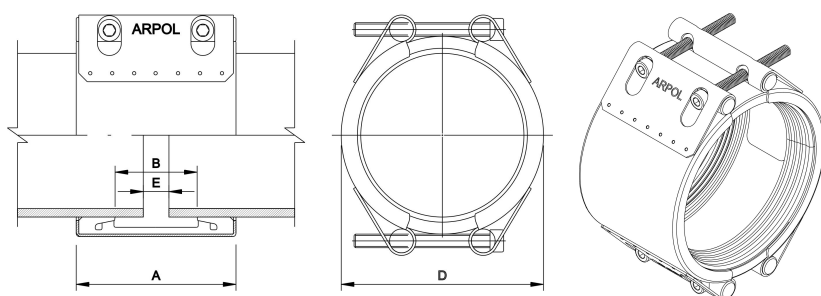

	Quality W5	
	AISI	DIN
Casing	316 L	1.4404
Bars	316 L	1.4404
Bolts	316	1.4401
Rubber gasket		
EPDM		
Suitable for water, air and some chemical products		



Range	Item	PS	Fac	Lock			Dimensions				Weight	Tolerances			
				Num	Diam	Tor	A	B	D	E		α	\odot	$\Delta\emptyset$	Crack
mm		bar				Nm	mm	mm	mm	mm	kg	°	mm	mm	mm
1097 - 1113	ICZR 1097-1113 A4E5	5	1.5	2	M16	90	200	142	1137	15	26	2	3	6	100
1226 - 1242	ICZR 1226-1242 A4E4	4	1.5	2	M16	100	200	142	1266	15	28	2	3	6	100
1497 - 1513	ICZR 1497-1513 A4E4	4	1.5	2	M16	120	200	142	1537	15	32.2	2	3	6	100

PS: Working pressure **Num:** Number of locks **Diam:** Bolt diameter **Tor:** Torque rate **Fac:** Factor test pressure: Factor x PS

α Maximum angular deflection

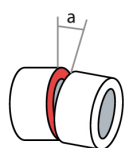

\odot Maximum misalignment

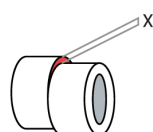

$\Delta\emptyset$ Maximum diameter difference

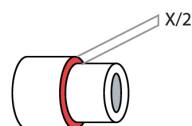

Dim E: Maximum gap width

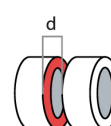

Crack: Maximum crack width



Remarks:

- For the correct operation of the coupling, fitting instructions must be respected. [REP](#)
- Inner steel band may be required for special applications (e.g. Risk of negative pressure)

Except errors / Subject to change without prior notice